

Bottom Fan Replacement

SOURCE:

<https://support.zortrax.com/m-series-bottom-fan-replacement/>

Table Of Contents

Unplugging the Power Cable
Changing the Printer's Position
Unscrewing the Bottom Plate, part 1
Turning the Printer
Unscrewing the Bottom Plate, part 2
Separating the Bottom Plate
Unscrewing the Bottom Fan
Bottom Fan Installation
Bottom Plate Installation
Securing the Bottom Plate, part 1
Turning the Printer
Securing the Bottom Plate, part 2
Changing the Printer's Position
Plugging the Power Cable

The bottom fan maintains the proper temperature around the motherboard and protects it from overheating. If you can hear a strange sound coming from the bottom of the machine, at first you should check if something is not obstructing the fan's blades from moving. If the blades do not rotate at all even though the printer is on, the fan is probably faulty and needs to be replaced. Follow the instructions from this manual to avoid motherboard failure in your printer.

The following manual shows the M200 repair work. For the M300, these procedures are the same.

Unplugging the Power Cable

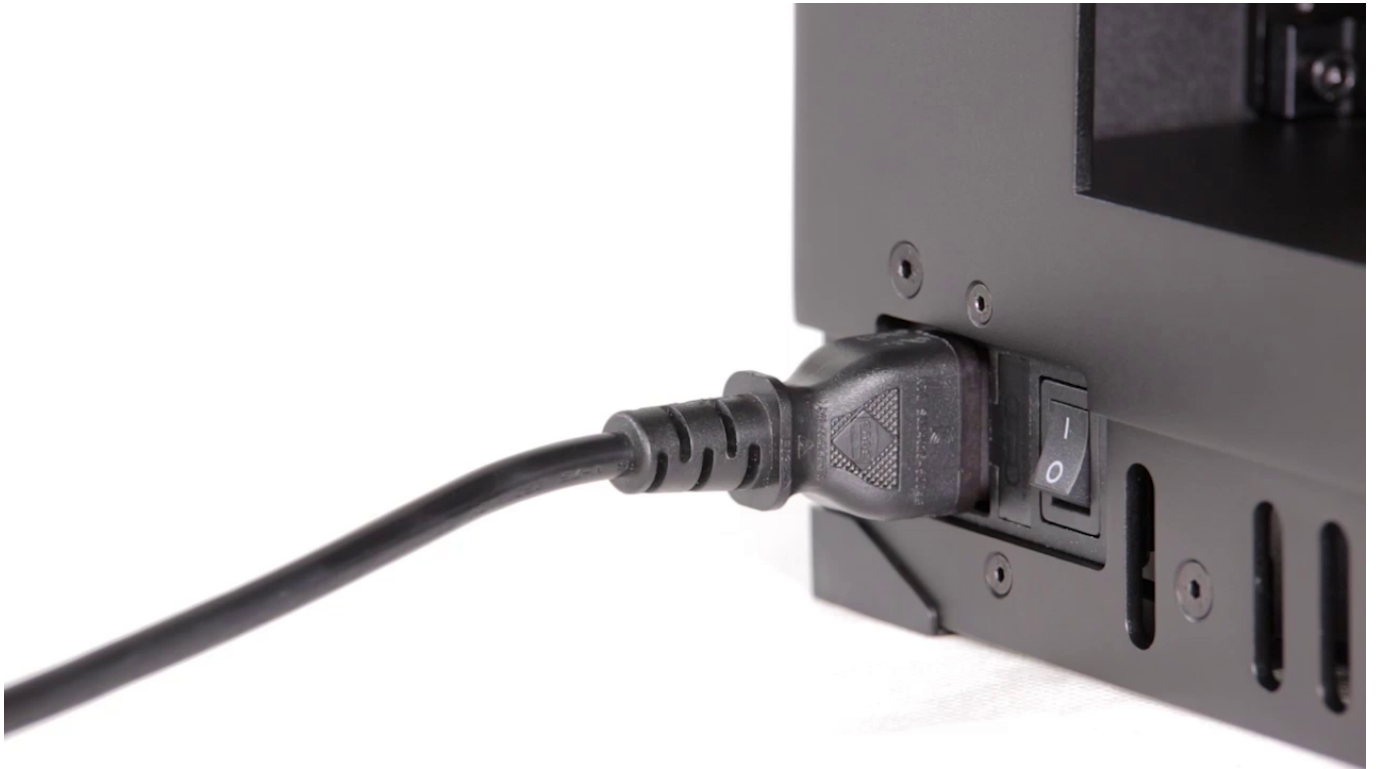

Turn off the machine and unplug the power cable. Wait a few minutes for all the capacitors to discharge.

Changing the Printer's Position



Grab the printer's housing and change the printer's position so that you can easily access the bottom plate.

Unscrewing the Bottom Plate, part 1



Unscrew the screws that secure the bottom plate on one side of the housing. Use a 2.5mm Allen key.

Turning the Printer



Turn the printer over.

Unscrewing the Bottom Plate, part 2



Unscrew the screws that secure the bottom plate on the other side of the housing. Use the same key.

Separating the Bottom Plate



Separate the bottom plate from the printer and unplug the bottom fan cable from the motherboard.

Unscrewing the Bottom Fan

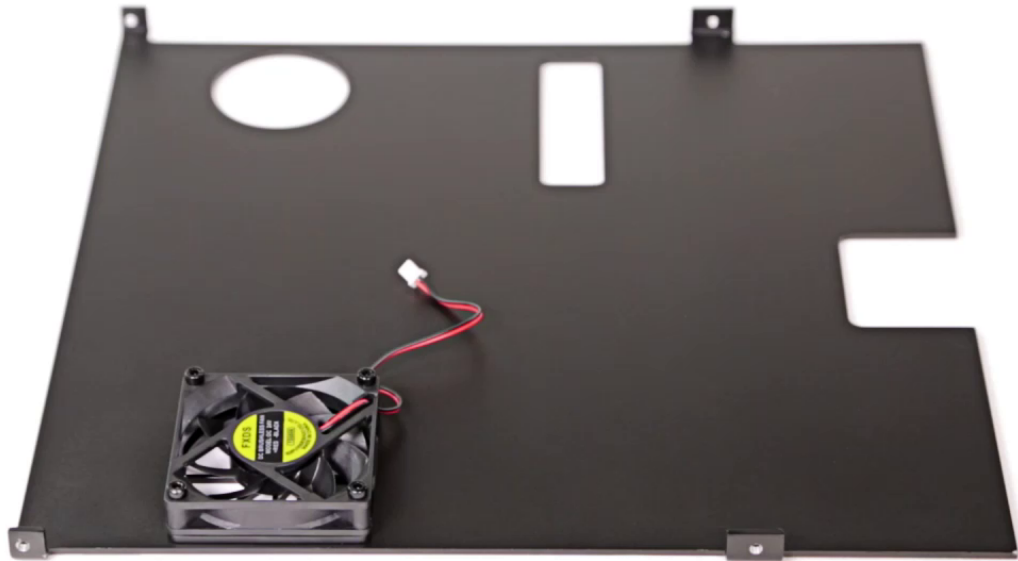

Unscrew the bottom fan from the plate using a 2.5 mm Allen key. Remove the bottom fan cable from the clamp and separate the fan from the bottom plate.

Bottom Fan Installation

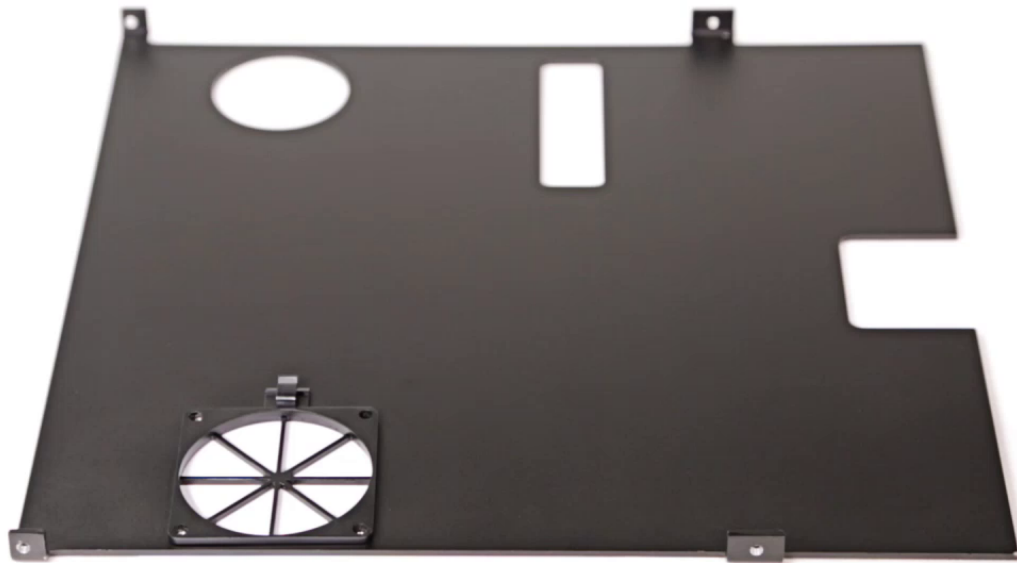

Bend the bottom fan cable and pass it through the clamp. Install the bottom fan in its place and secure it with the screws.

Bottom Plate Installation



Plug the bottom fan cable into the motherboard and install the bottom plate.

Securing the Bottom Plate, part 1



Secure the bottom plate with the screws on one side of the housing. Use a 2.5mm Allen key.

Turning the Printer



Turn the printer over.

Securing the Bottom Plate, part 2



Secure the bottom plate with the screws on the other side of the housing. Use the same key.

Changing the Printer's Position



Grab the printer's housing and set the printer upright.

Plugging the Power Cable



Plug the power cable in.